



MI-X100 Retro X User Manual

Important Safety Instructions

1. Please do not place device near any form of heat sources.
2. Please use the accessories specified by the manufacturer.
3. Please refer all servicing/repairs to a qualified personnel should there be any form of damage to the device.
4. Keep this user manual for future referencing/ troubleshooting.
5. Please heed ALL safety cautions.

Safety Cautions

1. Always keep device AWAY from fire and heat sources.
2. Do NOT attempt to disassemble or alter the device.
3. Do NOT expose device to excessive heat (Direct sunlight etc.).
4. Do NOT immerse device into any form of liquids.

Unboxing

- MI-X100 Retro X
- Type-C Charging Cable
- 3.5mm AUX Cable
- Handle
- User Manual

Please refrain from using any damaged components. Contact your local authorized AIWA distributor/customer service should you need any assistance.

Product Specifications

Model Number: MI-X100 Retro X
BT Version: V5.0
Power Output: 20W X 2
Driver: 3inch *2+2inch *2
Frequency Response: 120Hz~20kHz
S/N Ratio: 60dB
Supported Profiles: WMA, MP3, FLAC, MAV
Transmission Distance (Estimated): 10 Meters (No Obstacles)
DC Input Voltage/Current: DC 5V/ 2A (Type-C)
Battery: 7.4V/4000mAh (Li-on)
Playback Time: 9-11 Hours (50% Volume) ; 3-4 Hours (100% Volume)
Charging Time: 9-10 Hours
Dimensions: 252*160*142mm
Weight: 2.9KG

The above playback & charging times are estimated values tested in a practical environment and may vary upon individual usage habits.

Product Overview

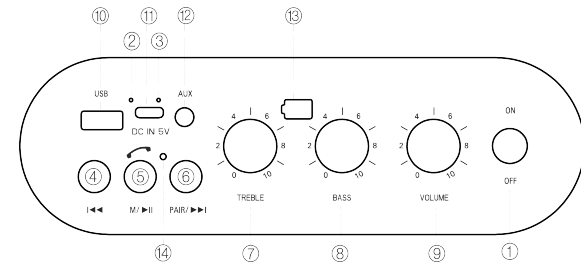

1. Power ON/OFF
2. Function LED Indicator Light
3. Charging LED Indicator Light
4. Previous Track
5. Play/Pause (Click once) / Switch Modes (Press and hold) / Call Control (Click once to Answer & End Call, Press and hold to Reject Call).
6. Next Track / Disconnect BT (Press and hold)
7. Treble Tuning Knob
8. Bass Tuning Knob
9. Volume Tuning Knob
10. USB Port
11. Charging Port (DC 5V)
12. AUX-In
13. Battery display
14. Phone call

Connecting the Product

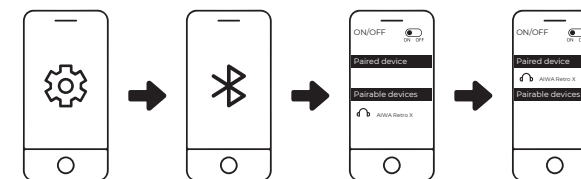

1. Turn on Bluetooth (BT) on your mobile device.
2. Turn on the speaker.
3. Search and connect to "AIWA Retro X" from your mobile device.
4. Press and hold the "PAIR" button to disconnect BT.

MI-X100 Retro X automatically reconnects to the last paired mobile device it was connected to.

TWS Function

Synced audio playback from two (2) speakers for true wireless stereo experience. (Only compatible with the same speaker model: MI-X100 Retro X)

1. Turn on both speakers.
2. Press and hold **⏪** on BOTH speakers until a notification prompt beep is heard.
3. TWS (True Wireless Stereo) playback is now available.
4. Connect to ONE (1) of the speakers via BT Connection.
5. Long press **⏪** to exit TWS mode.

Listening to music from external audio source

USB Playback
Insert USB Disk into the designated port.

AUX-IN
Connect speaker and Audio source via a 3.5mm AUX Cable.

Press and hold **M/||** button to switch between different audio sources

Battery & Charging

Connect charging cable to the speaker and a suitable power source.
Approximate Charging Time: 8-9 Hours
Please charge up the speaker fully prior to first-time usage.

MI-X100 Retro X will enter power-saving mode after 15 minutes of inactivity.
Long press "MODE" button for 3 seconds to exit power-saving mode.



Aiwa Electronics Int'l Co., Ltd.
Explore more at www.int-aiwa.com